

Public Hearing for 2021 Michigan Department of Natural Resources Grant Applications

February 23, 2021



2021 Applications:

1. Richmond Playground – Recreation Passport Grant
2. Rivers Edges Trail – Trust Fund Development
3. Plaza Roosevelt – Trust Fund Acquisition

Timeline:

- Submit Application – April 2021
- Notification of Award – December 2021
- Award Agreement – Spring 2022
- Construction (for development projects, if awarded) – FY23

Millage Investment, FY14-FY21	\$24,439,609	59%
Leveraged Investment, FY14-FY21	\$17,048,605	41%

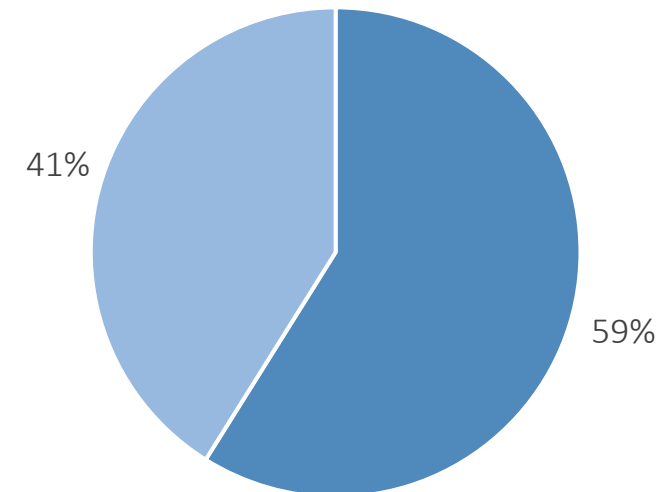

1. Richmond Park Playground Improvements

MDNR Passport Grant request:	\$150,000
<u>Matching funds (Millage + private*):</u>	<u>\$269,900</u>
Total Cost:	\$419,900

Features:

- New playground area with inclusive play equipment
- New poured-in-place surfacing
- New access pathways
- Site amenities
- Rain garden and landscaping with native plants

*Additional funding support from the Mitten Foundation and residents

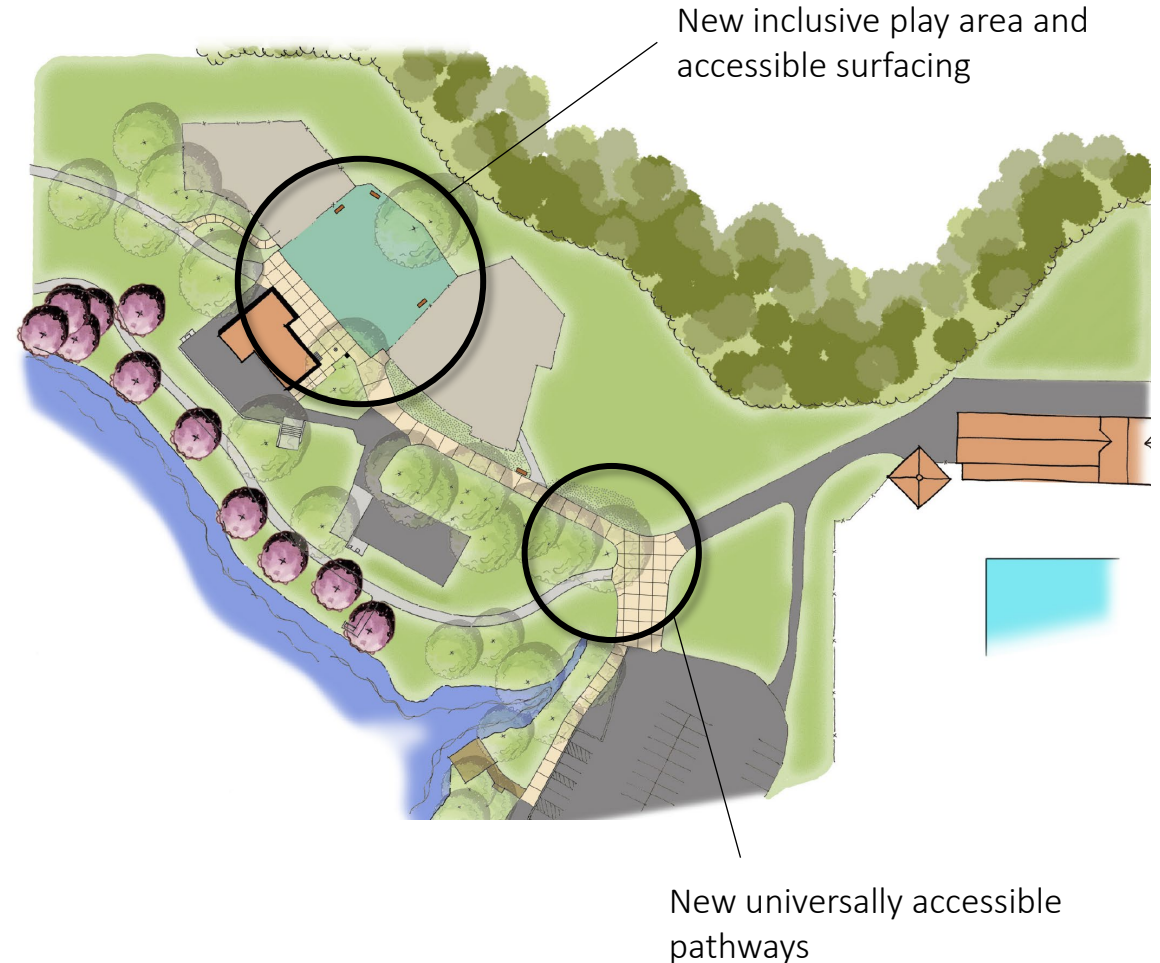

2. Rivers Edges Trail – Leonard Street to Ann Street

Project Segments:

1. Leonard St. underpass
2. Leonard Street to the Railroad property
3. Railroad property to Ann St.
4. Ann St. underpass

Estimated Total Project Cost: \$6,359,237

Anticipated funding sources:

- Michigan DNR Trust Fund
 - 4 applications of \$300,000 each
 - \$1,200,00 total request
- Parks Millage (MDNR match, 25%)
- Transportation Alternative Program (TAP)
- City Capital Reserve
- Private funding



3. Plaza Roosevelt Park Acquisition

MDNR Trust Grant request:	\$72,500
<u>Matching funds (Parks Millage):</u>	<u>\$26,000</u>
Total Cost:	\$98,500

Project Summary:

- 0.77-acre green space at Grandville Ave. & Rumsey St. SW
- Part of Plaza Roosevelt redevelopment:
 - Affordable housing (Habitat for Humanity, Dwelling Place)
 - Commercial space (Dwelling Place)
 - Southwest Community Campus High School (GRPS)
 - Neighborhood planning and activation (Roosevelt Park Neighborhood Association, Cook Arts Center, neighbors)

High priority acquisition:

- Located in Neighborhood of Focus
- Located in park-deficient neighborhood
- Site is easily accessible
- Partnerships in place

